

UniDoor

Pre-hung Design with Box Section frame

3-side frame with Auto Drop-Down Bottom Seal

For both Internal & External Application use

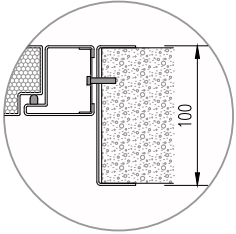
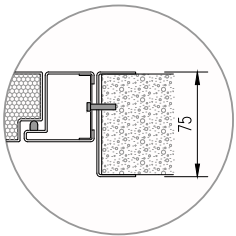
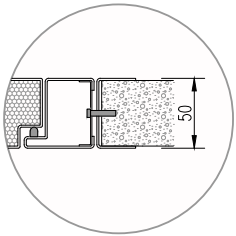

**Compatible with
different wall thickness**



Motisan Steel UniDoor are designed and engineered in Australia to meet Australian standards and requirements. These pre-hung steel doors feature an integrated structural design, allowing for easy installation in various wall systems, such as insulated panels, steel frames, and brick walls.

Integrated Structural Design

Cleanroom door design with a seamless, weld-free finish for easy cleaning and no dust collection.

Wall Compatibility

Compatible with wall thicknesses of $\geq 50\text{mm}$.

Airtightness

Rebate door leaf design equipped with continuously PU foam sealing and an automatic bottom seal for strong airtightness.

SPECIFICATIONS

| | | |
|--|--|---------------|
| Structural Material | Galvanised steel | |
| Steel thickness | Door leaf 0.8mm / Door frame 1.5mm | |
| Finish | UV-Resistant Powder coating | |
| Infill Insulation | Fire-resistant Rockwool(Mineral Wool) R-value 1.40 m²K/w | |
| Hinge | 3 Stainless Steel Hinges | |
| Size(mm) | Door leaf | Clear opening |
| | 820×2060×50 | 790×2045 |
| | 920×2060×50 | 890×2045 |
| | 1020×2060×50 | 990×2045 |
| customize for other size requirement | | |
| Product dimensions may change slightly due to ongoing iterations. For accurate cut-out dimensions, please contact our sales team. Dimension changes will not be notified separately. | | |
| Options | Double-glazing view windows Stainless steel kick plates Powder Coating in Various Colors | |

LOCKS

| Lever | DDA Compliant | Mortice |
|---|---|---|
|  |  |  |