

UniDoor

Pre-hung Design with Box Section frame

3-side frame with Auto Drop-Down Bottom Seal

For both Internal & External Application use

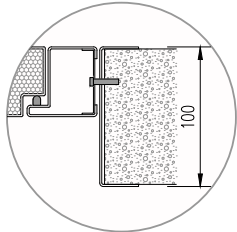
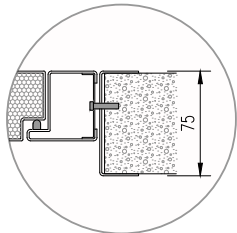
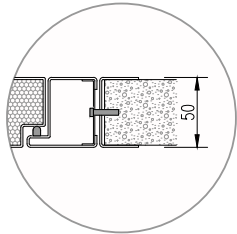

Compatible with different wall thickness



Motisan Steel UniDoor are designed and engineered in Australia to meet Australian standards and requirements. These pre-hung steel doors feature an integrated structural design, allowing for easy installation in various wall systems, such as insulated panels, steel frames, and brick walls.

Integrated Structural Design

Cleanroom door design with a seamless, weld-free finish for easy cleaning and no dust collection.

Wall Compatibility

Compatible with wall thicknesses of $\geq 50\text{mm}$.

Airtightness

Rebate door leaf design equipped with continuously PU foam sealing and an automatic bottom seal for strong airtightness.

SPECIFICATIONS

Structural Material	Galvanised steel	
Steel thickness	Door leaf 0.8mm / Door frame 1.5mm	
Finish	UV-Resistant Powder coating	
Infill Insulation	Fire-resistant Rockwool(Mineral Wool) R-value 1.40 m ² K/w	
Hinge	3 Stainless Steel Hinges	
Size(mm)	Door leaf	Clear opening
	820×2060×50	790×2045
	920×2060×50	890×2045
	1020×2060×50	990×2045
	customize for other size requirement	
	Product dimensions may change slightly due to ongoing iterations. For accurate cut-out dimensions, please contact our sales team. Dimension changes will not be notified separately.	
Options	Double-glazing view windows Stainless steel kick plates Powder Coating in Various Colors	

LOCKS

Lever	DDA Compliant	Mortice
		

COLOUR



PC Monument



PC Surfmist



PC Windspray



PC Basalt



Light Oak



PC Surfmist



PC Windspray